

Surge Protection Network

BATTERY LINE PROTECTORS

MODEL SP17-1A MODEL SP17-1B
 MODEL SP18-1A MODEL SP18-1B
 MODEL SP19-1A MODEL SP19-1B

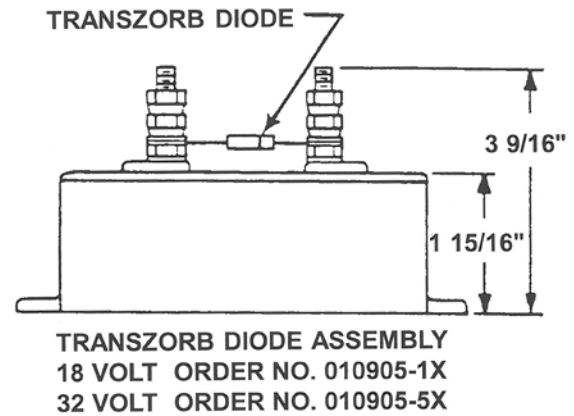
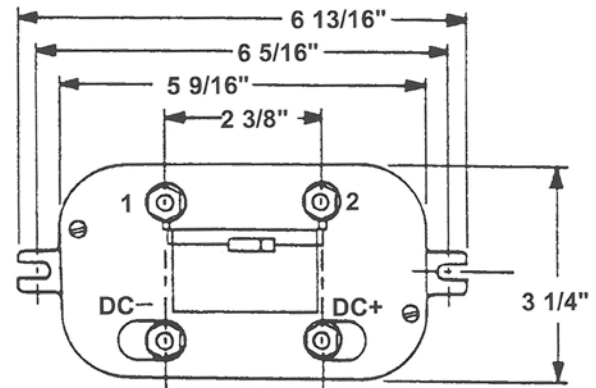
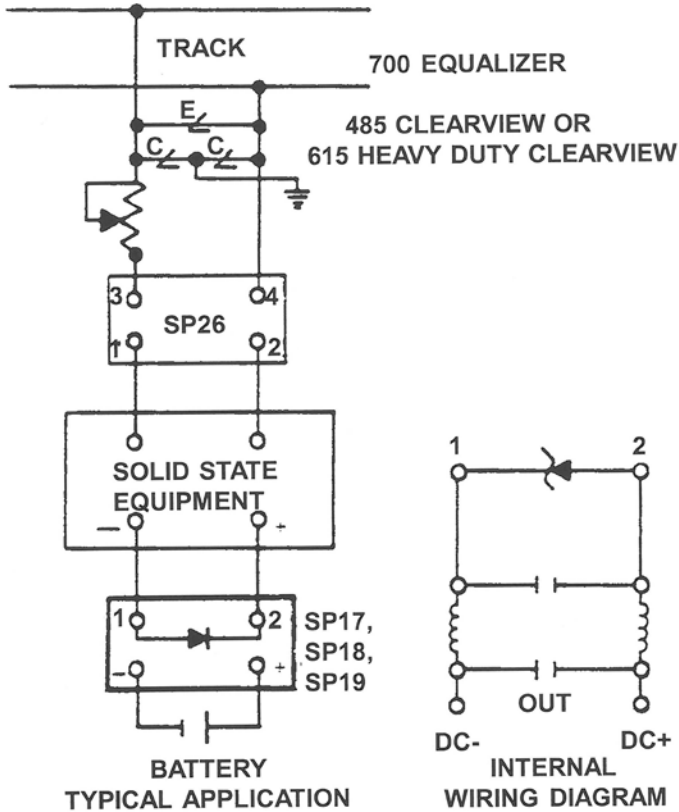

TO ORDER: SPECIFY SURGE PROTECTION NETWORK, MODEL NUMBER AND ASSEMBLY NUMBER

MODEL NUMBER	ASSEMBLY NUMBER	VOLTAGE D.C. MAXIMUM	CURRENT AMPERAGE MAXIMUM	RESISTANCE OHM PER LINE	INDUCTANCE MICROHENRY PER LINE
SP17-1A	010804-AX	18	1.5	1.1	550
SP17-1B	010804-BX	32	1.5	1.1	550
SP18-1A	010805-AX	18	5	0.35	185
SP18-1B	010805-BX	32	5	0.35	185
SP19-1A	010806-AX	18	10	0.02	18
SP19-1B	010806-BX	32	10	0.02	18

NOTE: BATTERY WIRES MUST BE #12 OR LARGER, OR A FUSE MUST BE USED TO PREVENT DAMAGE, IF TRANSZORB DIODE FAILS.