



SIEMENS

Ingenuity for life

EV charging network solutions

Managing public and workplace charging

Siemens offers a variety of cloud service packages designed to simplify management and control of EV chargers. The flexibility of our services combined with our ecosystem of partners allows for varying levels of control in parking garages, hotels, hospitals, universities, industrial buildings, malls, retail / convenience stores, multi-family dwellings, and more. Integration into common building management systems and partner EV-solution provider networks expand the offerings to create a seamless, easy-to-use system with a simple user interface.

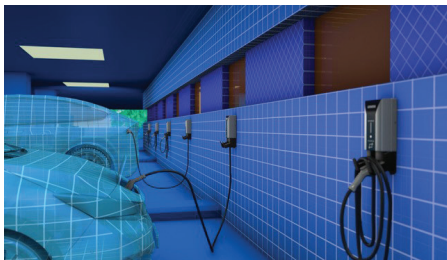

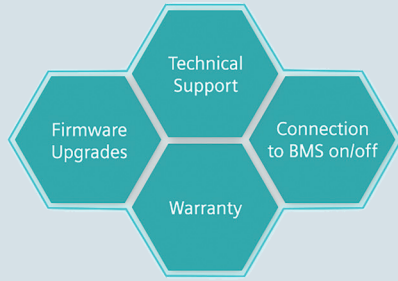

Care

Care package

Included with all the Siemens EV chargers, the Care package provides technical support, device updates, driver onboarding, setup configuration, and a mobile app for monitoring and basic control. This package provides your charger is up to date and provides piece of mind that support is at your fingertips!

Get more from your chargers with our Connect, Charge, and Control options

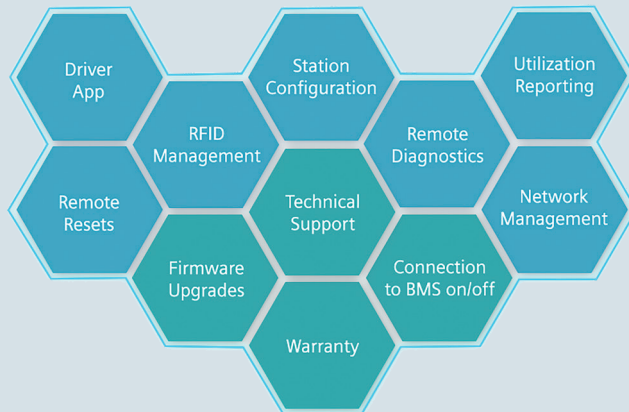

Connect

- **Connect package-**

The Connect package maintains all the functionality of the Care package and enables users and owners to get a holistic view of the chargers they control along with an aggregated view of data gathered by those chargers. They also gain access to the Location Manager that shows where and how the chargers are being used, a Driver App, RFID setup for groups of chargers, and advanced remote diagnostics to give the charger owner more detailed information to manage the charging infrastructure.

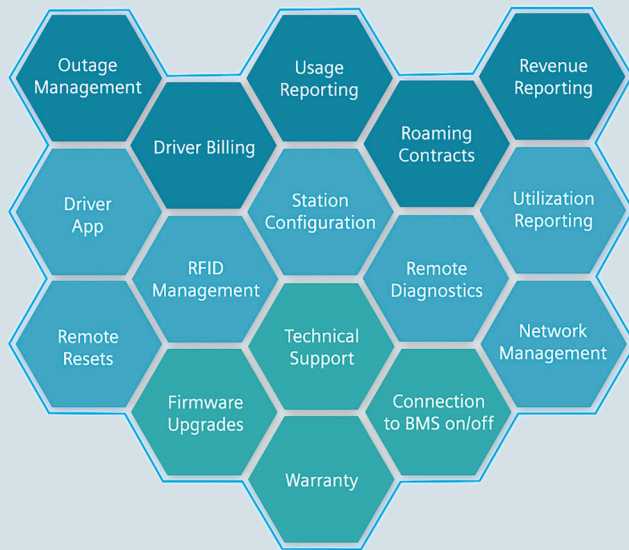

Charge

- **Charge package-**

The Charge package includes all functions of the Connect package, offers comprehensive financial and consumption reporting, billing and payment management for owners. This package is perfect for collecting revenue from charging stations within general public areas, or at a workplace environment where fleet and employee charging times and rates are different. The Charge package also enables charging stations to be seen and accessed within other charging networks. This allows public charging stations to be seen from other networks, when they are part of the Siemens Charge package solution, increasing visibility and usage.



Control

- **Control package-**

The Control package continues capability expansion by supplying all of the same functions as the Charge package, and adds on cloud smart charging capabilities. The smart charging feature provides dynamic load management and maximum load control for situations where limited power is available for chargers or maximum demand constraints where tariffs are in place. This package allows piece of mind that power sharing chargers are not exceeding equipment load, or that the facility's peak demand levels are not exceeded.

Feature	Care	Connect	Charge	Control
Technical Support	x	x	x	x
Remote Firmware Upgrades	x	x	x	x
Charger Setup	x	x	x	x
Remote Resets		x	x	x
Remote Diagnostics		x	x	x
RFID Management		x	x	x
Aggregated Charger Reporting		x	x	x
Driver App		x	x	x
Driver Billing			x	x
Charger Network Visibility			x	x
Dynamic Load Control				x
Max Load Management				x

These packages set the stage for the public workspace of the future where distributed generation and local micro grids are integrated into one common Smart Energy ecosystem. All of this provides you with the ultimate in functionality, both now and wherever the electric road will lead you.

Published by Siemens Industry, Inc. 2020

Siemens Industry, Inc.
3617 Parkway Ln
Peachtree Corners, GA 30092

Customer Support Center:
Phone: +1 (800) 333-7421
usa.siemens.com/eMobility

Order No. SIDS-B40069-00-4AUS
Printed in USA
All Rights Reserved
© 2020, Siemens Industry, Inc.

The technical data presented in this document is based on an actual case or on as-designed parameters and, therefore, should not be relied upon for any specific application and does not constitute a performance guarantee for any projects. Actual results are dependent on variable conditions. Accordingly, Siemens does not make representations, warranties, or assurances as to the accuracy, currency, or completeness of the content contained herein. If requested, we will provide specific technical data or specifications with respect to any customer's particular applications. Our company is constantly involved in engineering and development. For that reason, we reserve the right to modify, at any time, the technology and product specifications contained herein.