

REVISION	DATE	BY	DATE	BY
1	08/05/16	CY	04/06/08	LR
2	12/03/10	RB		

Confidential - Property of Siemens Industry, Inc. Building Technologies Division		
CUSTOMER		
ORDER NO.	DWG. NO.	2
1D1Y075FCTP1		SH 1 OF 2

SIEMENS

CATALOG NO. 1D1Y075FCTP1
 SERIAL NO. SERIES H
 75 kVA 60 Hz 1 PHASE
 5.4 % IMP AT 135 °C
 115 °C RISE °C AVG. AMBIENT
 220 °C TEMP CLASS °C MAX. AMBIENT
 PRIMARY (H1 H3 H2 H4) 240X480 V
 SECONDARY(X4 X2 X3 X1) 120/240 V
 WINDING MATERIAL CU
 ENCLOSURE TYPE NEMA-3R WEIGHT 655 LBS
 ENERGY EFFICIENCY CSA - NEMA TP 1-2002

SPACINGS BETWEEN ENCLOSURE AND ANY ADJACENT WALL SHALL BE A MINIMUM OF 5 INCHES
 LISTED DISTRIBUTION TRANSFORMER 77US TYPE F
 LR 3902

 E112313
 SUITABLE FOR INDOOR OR OUTDOOR LOCATIONS DO NOT INSTALL IN AREAS ACCESSIBLE TO PUBLIC NE PAS INSTALLER DANS DES ENDROITS ACCESSIBLES AU PUBLIC FOR INSTALLATION SEE INSTRUCTION MANUAL

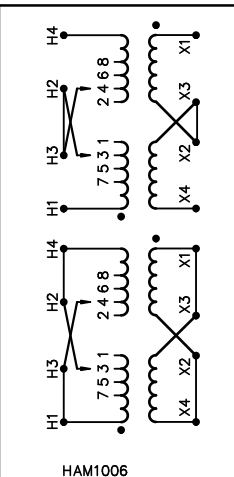
NEMA Class ANN Dry Type Transformer Siemens Industry, Inc. Norcross, GA



VOLTS	INPUT LINE ON H1 & H4 CONNECT
504	H2-1, H3-2
492	H3-2, H2-3
480	H2-3, H3-4
468	H3-4, H2-5
456	H2-5, H3-6
444	H3-6, H2-7
432	H2-7, H3-8
252	H2-1, H3-2
240	H2-3, H3-4
228	H2-5, H3-6
216	H2-7, H3-8

VOLTS	CONNECT	OUTPUT LINE
120	X1-X3, X2-X4	X1-X4
240	X2-X3	X1-X4
120/240	X2-X3	X1-X2-X4

dsu0082e1



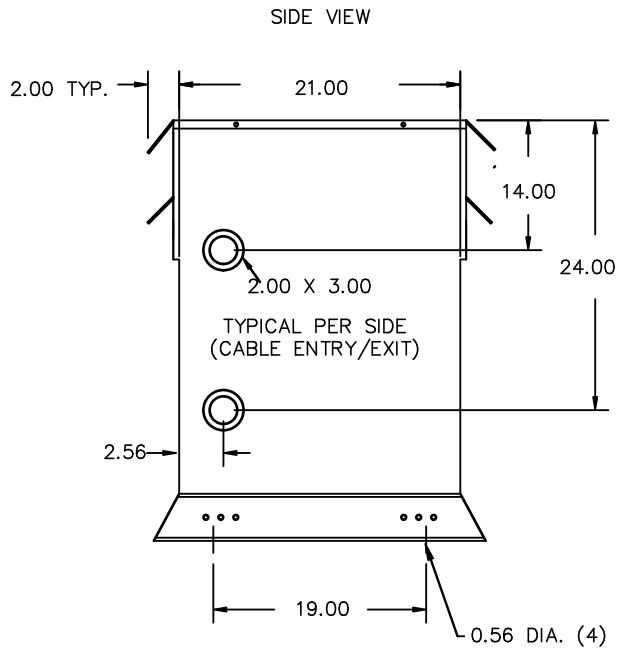
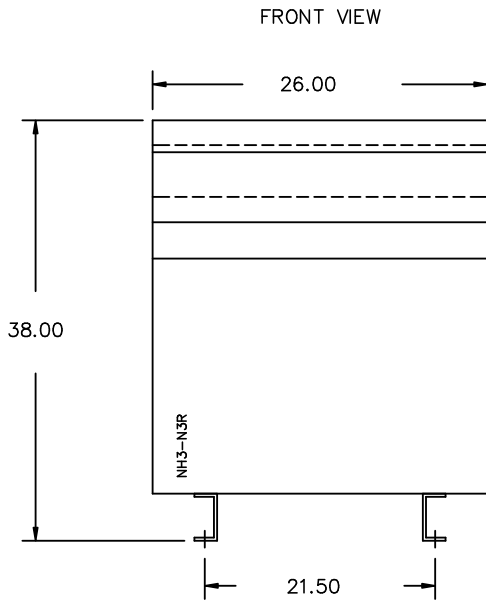

All Dimensions in inches

ENCLOSURE COLOR :ANSI 61 GREY- OUTDOOR

H.V.1. TERMINAL DETAIL

L.V.1. TERMINAL DETAIL

MECHANICAL TYPE LUGS INCLUDED
SUITABLE FOR 350MCM-6 CU/AL
CONDUCTORS
1 CONDUCTOR PER PHASE

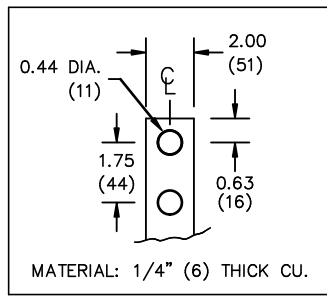

CUSTOMER NOTES:

- HV1 TERMINATED AT TOP FRONT
- LV1 TERMINATED AT BOTTOM FRONT

Confidential - Property of
Siemens Industry, Inc.
Building Technologies Division

REVISION	DATE	BY	DATE	BY
			04/06/08	LR
1	08/05/16	CY		
2	12/03/10	RB		

CUSTOMER		
ORDER NO.	DWG. NO.	2
	1D1Y075FCTP1	SH 2 OF 2

2.0 dclarke 2013/08/23 15:41