

REVISION	DATE	BY	DATE	BY
		DRAWN	05/01/24	GP
		CHEK'D		
		VERIF'D		

Confidential - Property of Siemens Industry, Inc. Building Technologies Division	
CUSTOMER	
ORDER NO.	DWG. NO.
	1D1Y167CTP1
	SH 1 OF 2

SIEMENS



CATALOG NO. 1D1Y167CTP1
 SERIAL NO. SERIES H
 167 kVA 60 Hz 1 PHASE
 5.4 % IMP AT 170 °C

150 °C RISE 30 °C AVG. AMBIENT
 220 °C TEMP CLASS 40 °C MAX. AMBIENT
 PRIMARY (H1 H3 H2 H4) 240X480V V
 SECONDARY(X4 X2 X3 X1) 120/240V V

WINDING MATERIAL CU
 ENCLOSURE TYPE NEMA-3R
 WEIGHT 1150 LBS

SPACINGS BETWEEN ENCLOSURE AND ANY ADJACENT WALL SHALL BE A MINIMUM OF 6 INCHES
 UNIT MEETS TP1-1996 EFFICIENCY
 SUITABLE FOR INDOOR OR OUTDOOR LOCATIONS DO NOT INSTALL IN AREAS ACCESSIBLE TO PUBLIC FOR INSTALLATION SEE INSTRUCTION MANUAL

NEMA Class ANN Dry Type Transformer Siemens Industry, Inc. Norcross, GA

E112313 LR 3902
 LISTED DISTRIBUTION TRANSFORMER 77US



1D1Y167CTP1

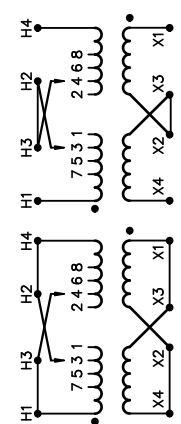

HAM1006

VOLTS		INPUT LINE ON H1 & H4
504	H2-1, H3-2	CONNECT
492	H3-2, H2-3	
480	H2-3, H3-4	
468	H3-4, H2-5	CONNECT
456	H2-5, H3-6	H2 TO H3
444	H3-6, H2-7	FOR SERIES
432	H2-7, H3-8	PRIMARY
252	H2-1, H3-2	CONNECT
240	H2-3, H3-4	H1 TO H3 AND
228	H2-5, H3-6	H2 TO H4 FOR
216	H2-7, H3-8	PARALLEL PRIMARY

VOLTS		CONNECT	OUTPUT LINE
120	X1-X3, X2-X4		X1-X4
240	X2-X3		X1-X4
240/120	X2-X3		X1-X2-X4

dsu0602e

FRONT VIEW

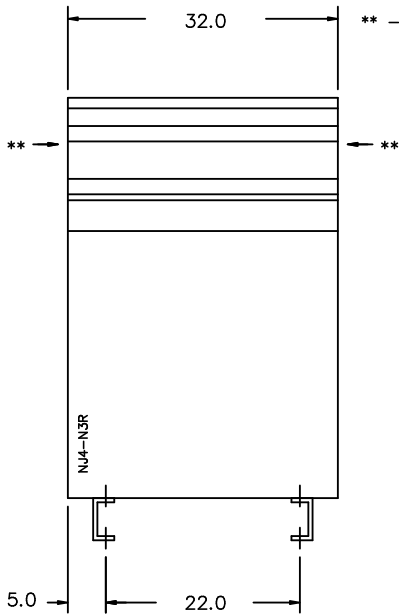

** - Recommended cable entry locations only
cutouts & gland plates not provided.

SIDE VIEW

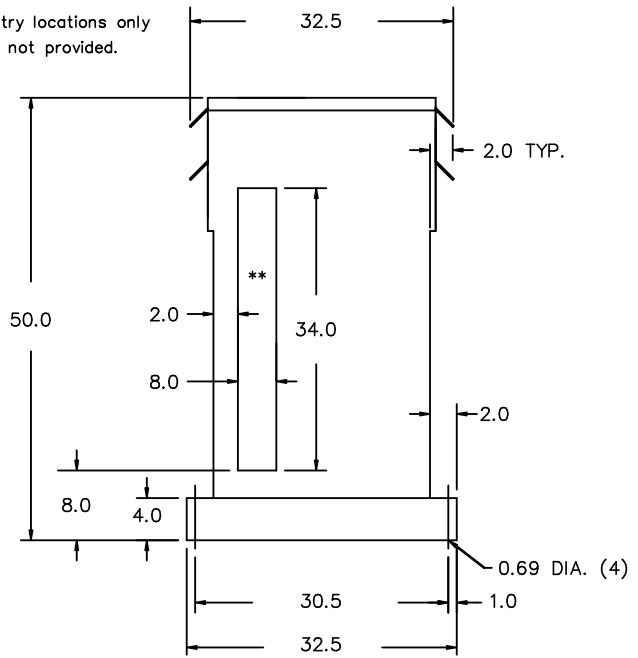

All Dimensions in inches

ENCLOSURE COLOR : ANSI 61 GREY - OUTDOOR

H.V.1. TERMINAL DETAIL

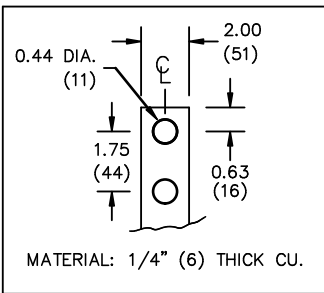

L.V.1. TERMINAL DETAIL

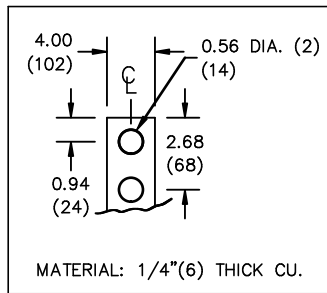

CUSTOMER NOTES:

- HV1 TERMINATED AT TOP FRONT
- LV1 TERMINATED AT BOTTOM FRONT

Confidential - Property of
Siemens Industry, Inc.
Building Technologies Division

REVISION	DATE	BY	DATE	BY
		DRAWN	05/01/24	GP
		CHEK'D		
		VERIF'D		

CUSTOMER

ORDER NO.

DWG. NO.

1D1Y167CTP1

SH 2 OF 2

0.2 jwen 2010/01/21 13:28