

TYPE

EQ8693 (150A)

EQ8695 (200A)

EQ8696 (225A)

THIS KIT CONTAINS

- (1) BREAKER
- (2) HEX NUTS

	<p>! DANGER</p> <p>Hazardous voltage. Will cause death or serious injury.</p> <p>Turn off power supplying equipment before installing the Circuit Breaker to the Load Center Base Pan.</p>
---	---

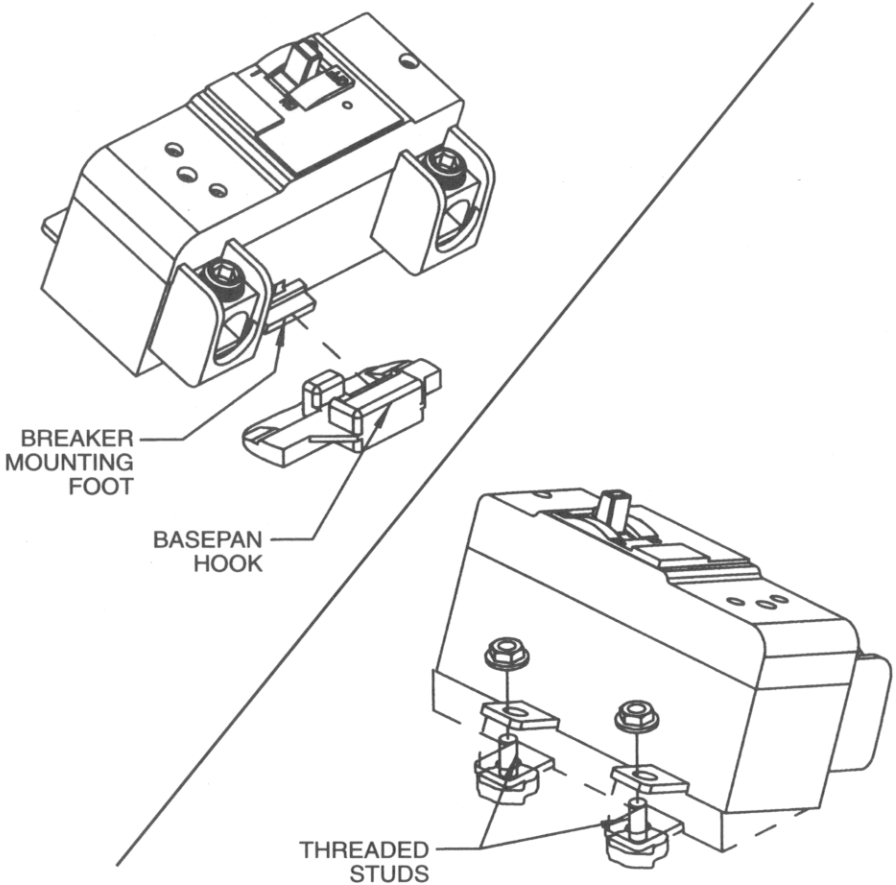

TO INSTALL, REMOVE CONNECTORS FROM LOAD CENTER. INSERT THE BREAKER FOOT INTO THE BASEPAN HOOK AS SHOWN. ROTATE THE BREAKER ALLOWING THE (2) THREADED STUDS TO PASS THROUGH THE TERMINAL SLOTS. ATTACH USING THE TWO HEX NUTS AND TORQUE TO 50 LB-IN.