

DETAIL "A"

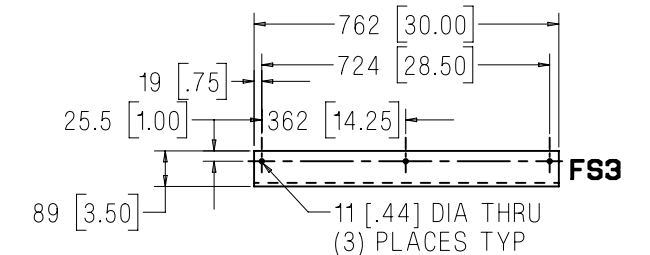
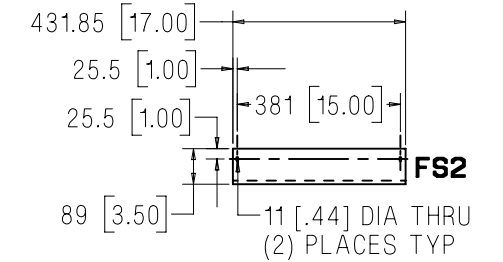

BOX FEET DIMENSIONS

Standard Dimensions in Millimeters (Inches)

SHAFT DIA	TOLERANCE
220 (8.66)	+0.037 (+0.0015) +0.017 (+0.0007)

Notes:

1. The FS2 and FS3 conduit boxes are free standing and must be supported from below by the customer. A removable bottom plate is supplied on the FS2 and FS3 conduit boxes.
2. L (C) = Length of motor from drive end of shaft to end of non-drive end of motor.
3. Machines rotate in one direction only.
4. Shims may be necessary under motor feet for direct connection.
5. The standard shaft seal is rated IP55.
6. The water cooler inlet and outlet is always located opposite main terminal box.

Standard Dimensions in Millimeters (Inches) *IEC Designations (NEMA)

Shaft	Frame	Speed	A (2E)	B (2F)	C (BA)	L (C)	- LE	E (N-W)	- (R)	- (S)	- (T)	D (U)	- (ES)	Approx. Max Wt. kgs (lbs)
Short	630/2	6 Pole +	1320 (51.96)	1600 (62.99)	335 (13.19)	2500 (98.42)	2322 (91.42)	280 (11.02)	203 (7.99)	50 (1.97)	28 (1.10)	220 (8.66)	230 (9.06)	11050 (24400 lbs)
Short	634/6	6 Pole +	1320 (51.96)	1800 (70.87)	335 (13.19)	2740 (107.87)	2562 (100.87)	280 (11.02)	203 (7.99)	50 (1.97)	28 (1.10)	220 (8.66)	230 (9.06)	12750 (28100 lbs)

Certification:

Customer _____ P.O. _____ S.O. _____ Item _____
 HP _____ RPM _____ Frame _____ PH/HZ/Volts 3/_____/_____
 Terminal Box Size FS2 FS3
 Customer Tag # _____ By _____ Date _____
 Comments _____
 Not for construction, installation or application purposes unless certified.

A5E31871001A
TEWAC_630_6plusPL_AF_FS
Revision AB
7-26-13