

TPS3 05

Type 1 / 2 Surge Protection Device (SPD) for P4 & P5 Panelboards and Distribution Switchboards

Features:

- Mounts internal to:
 - P4 & P5 panelboards and distribution switchboards
- UL 1449-4 Type 2 SPD, UL 1283 Listed, CSA 22.2 No. 269.2
- Optional UL 1449 4th Edition Recognized Type 1, CSA 22.2 No. 269.1
- Type 1 / Type 2 SPD
- Large block, individually fused, thermally protected, 50 kA MOVs
- 20 kA I_n
- 200 kA SCCR (most models)
- All UL required OCP & safety coordination included
 - Type 1 SPDs intended for Line or Load side of Main Disconnect
 - Type 2 SPDs intended for Load side of Main Disconnect
- UL96A Lightning Protection Master Label compliant
- Designed, manufactured and tested consistent with:
 - ANSI/IEEE C62.41.1-2002, C62.41.2-2002, C62.45-2002, C62.62-2010, C62.72-2016 & CSA C22.2 No. 269.1 and .2
 - 1992/2000 NEMA LS-1
 - NEC Article 285
 - IEC 61643, CE
- 10 year warranty
- Panelboard Features
 - Copper or aluminum bus
 - MB or MLO

SPD Specifications

Surge Current Rating Per Phase

Per Phase	L-N	L-G	N-G
100 kA	50 kA	50 kA	50 kA
150 kA	100 kA	50 kA	50 kA
200 kA	100 kA	100 kA	100 kA
250 kA	150 kA	100 kA	100 kA
300 kA	150 kA	150 kA	150 kA

- 100% monitoring (Every MOV is monitored, incl. N-G)
- EMI/RFI filtering: Active tracking up to -50 db from 10 kHz to 100 MHz (Type 2 option only, includes UL 1283 Listing)
- Repetitive impulse: 5,000 hits
- Less than 1/2 nanosecond response time
- Relative humidity range: 1-95% non-condensing
- Operating frequency: 47-63 Hz
- Operating temperature: -25°C (-15°F) to +60°C (140°F)
- Switchboard Features
 - Copper or aluminum bus
 - 200% rated neutral bus for harmonic-rich applications
 - CSA, UL 891, UL 67 and NEMA PB-2
- Applications
 - Provides main service entrance or downstream protection for sensitive computer and electronic loads
 - Std. redundancy use: 100kA/phase
 - Inc. redundancy use: 200kA/phase
 - Max. redundancy use: 300kA/phase

- SPD Monitoring
 - LED indicators
 - Audible alarm with silence switch and test button
 - Dry contacts
 - Surge counter
 - Internal rotary disconnect switch



Ordering Information

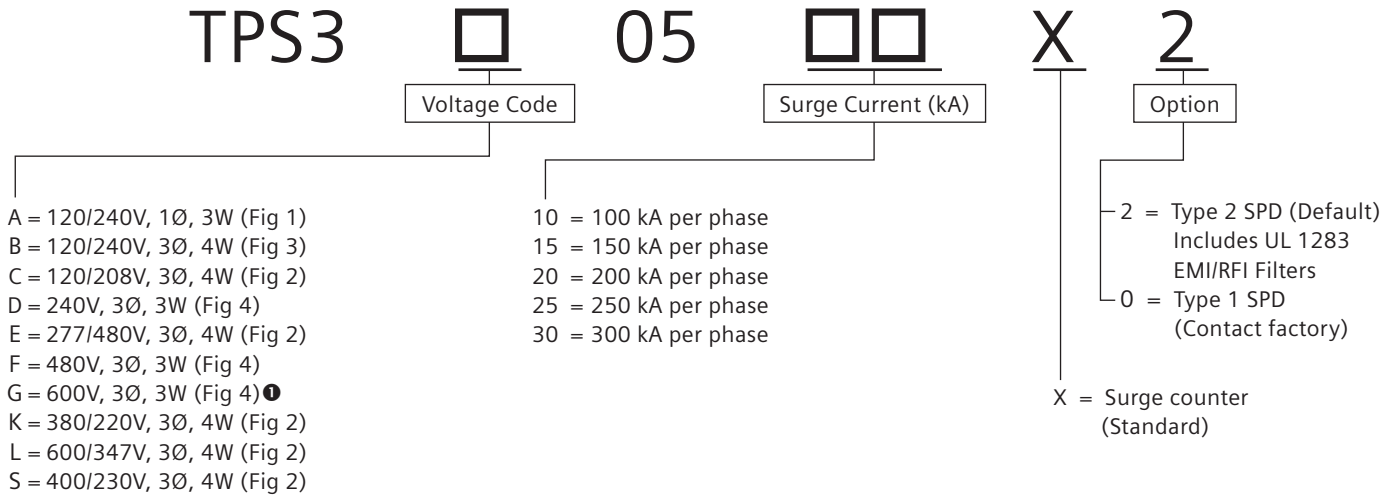

Example: TPS3C0530X2 = Type 2 SPD (Default) for a 208/120V power panel with a surge current capacity of 300 kA per phase and a surge counter.

**Available Accessories:
Ordered Separately**
RMSIE - Remote monitor

UL 1449 Fourth Edition - Test Data Voltage Protection Rating (VPR - 6 kV, 3 kA)								
Voltage Code	Service Voltage	L-N	L-G	N-G	L-L	I _n	SCCR	MCOV
A	120/240V, 1Ø, 3W (Fig 1)	700	700	700	1200	20 kA	100 kA	150
B	120/240V, 3Ø, 4W (Fig 3)	700 /1500	700 /1200	700	1800/1800	20 kA	200 kA	150 / 320
C	120/208V, 3Ø, 4W (Fig 2)	700	700	700	1200	20 kA	200 kA	150
D	240V, 3Ø, 3W (Fig 4)	—	1200	—	1500	20 kA	200 kA	320
E	277/480V, 3Ø, 4W (Fig 2)	1200	1200	1200	2000	20 kA	200 kA	320
F	480V, 3Ø, 3W (Fig 4)	—	1800	—	1800	20 kA	200 kA	552
G	600V, 3Ø, 3W (Fig 4)	—	2500	—	2500	20 kA	200 kA	690
K	380/220V, 3Ø, 4W (Fig 2)	1500	1200	1200	2500	20 kA	200 kA	320
L	600/347V, 3Ø, 4W (Fig 2)	1500	1500	1500	2500	20 kA	200 kA	420
S	400/230V, 3Ø, 4W (Fig 2)	1500	1200	1200	2500	20 kA	200 kA	320

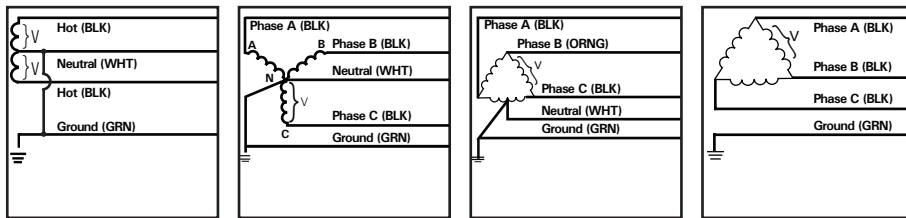

Figure 1
Split
2 Hots, 1 Neu, 1 Grnd

Figure 2
Wye
3 Hots, 1 Neu, 1 Grnd

Figure 3
Hi-Leg Delta (B High)
3 Hots, (B High),
1 Neu, 1 Grnd

Figure 4
Delta & HRG Wye
3 Hots, 1 Grnd

Siemens Industry, Inc.
5400 Triangle Parkway
Norcross, GA 30092

888-333-3545
info.us@siemens.com

Order No. RPFL-S305C-1017
Printed in USA
All Rights Reserved.

©2017 Siemens Industry, Inc.

The technical data presented in this document is based on an actual case or on as-designed parameters, and therefore should not be relied upon for any specific application and does not constitute a performance guarantee for any projects. Actual results are dependent on variable conditions. Accordingly, Siemens does not make representations, warranties, or assurances as to the accuracy, currency or completeness of the content contained herein. If requested, we will provide specific technical data or specifications with respect to any customer's particular applications. Our company is constantly involved in engineering and development. For that reason, we reserve the right to modify, at any time, the technology and product specifications contained herein.

Notes:

❶ Available 100 kA & 150 kA only

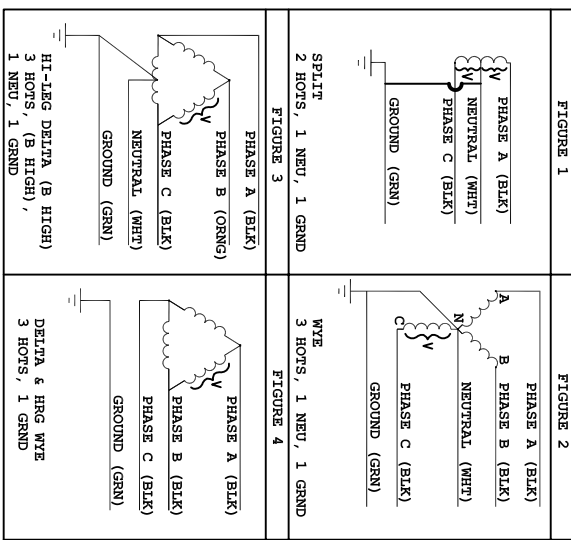

MODEL	VOLTAGE CODE	SERVICE VOLTAGE	FIGURE
TPS3A05/L15	A	240/120V 1Ø, 3W Plus Ground	1
TPS3B05/L15	B	240/120V 3Ø, 4W Plus Ground High Leg Delta	3
TPS3C05/L15	C	208Y/120V 3Ø, 4W Plus Ground	2
TPS3D05	D	240V 3Ø, 3W Plus Ground	4
TPS3E05/L15	E	480Y/277V 3Ø, 4W Plus Ground	2
TPS3F05	F	480V 3Ø, 3W Plus Ground	4
TPS3G05	G	600V 3Ø, 3W Plus Ground	4
TPS3H05/L15	K	380Y/220V 3Ø, 4W Plus Ground	2
TPS3I05	L	600Y/347V 3Ø, 4W Plus Ground	2
TPS3S05/L15	S	400Y/230V 3Ø, 4W Plus Ground	2

CUSTOMER CONNECTIONS PER FIGURES AT LEFT
THREE POLE

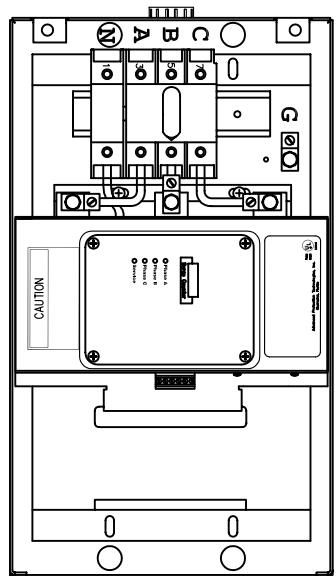

TWO POLE

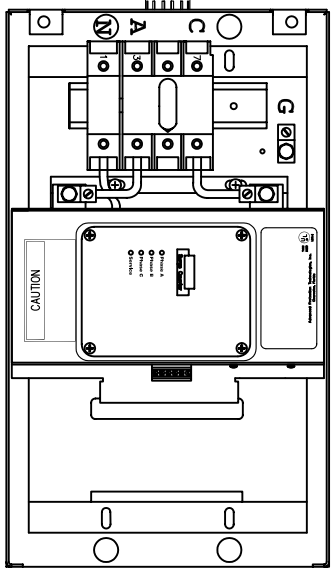

Rev	C.N.	Date	3-26-10
Δ - Denotes latest changes. □ - Critical dimension.			
DESIGN: H. BROCKERS DRAWN: M.S. APPROVAL:			
Confidential - Property of Siemens Industry, Inc.		TPS3-05 SERIES ELECTRICAL	
DATE	43D-TPS3-05-E	SHEET	1 of 1

SURGE PROTECTIVE DEVICE (SPD)
WEIGHTS & DIMENSIONS
NEMA RATING: 1

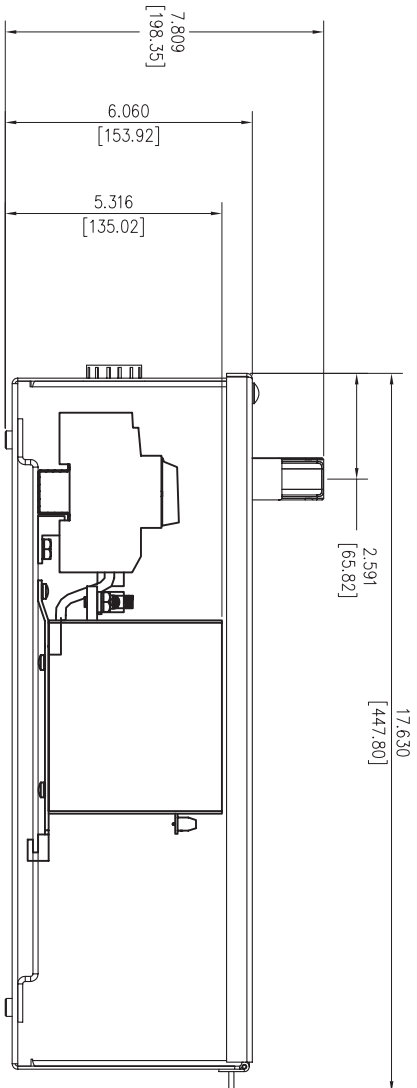
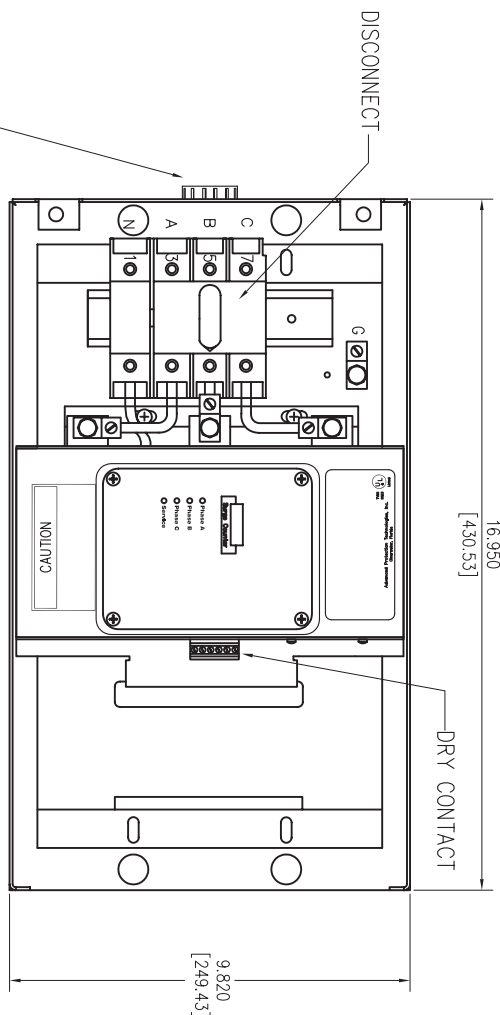
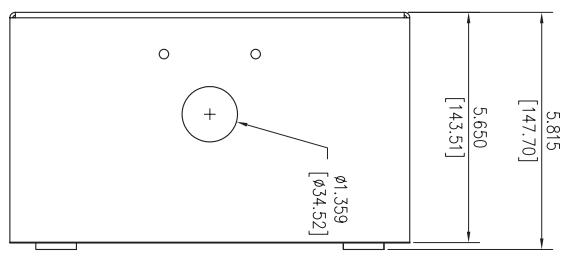

ENCLOSURE SPECS:
DESC: U10E10 ENCLOSURE, HINGED
DIM: 10"H x 17"W x 6"D
MAT: GALVANNEAL, 16 GAUGE
FINISH: POWDERCOAT ANSI 61 GRAY
NEMA RATING: 1
DEVICE WEIGHT: 9.4 LBS. (4.2KG.)

Rev	C.N.	Date
A		3-26-10

- Denotes latest changes.
 - Critical dimension.

DESIGNED BY	H. DRINGERS	DATE	6/17/20
CHECKED BY		DATE	
APPROVED BY		DATE	

Confidential - Property of
Siemens Industry, Inc.
 TPS3-05 SERIES
 100K-300K
 IN U10E10 ENCLOSURE
 Dwg No: 43D-TPS3-05-M
 Scale: NONE
 Sheet: 1 of 1