

SIEMENS

P1SCRWS BRANCH CONNECTOR SCREW KIT INSTRUCTIONS

CAUTION:

Use only special 10-32 by 9/32" pre-assembled screw / cup washer fasteners included with the panelboard to install branch breakers.

Torque to 20 lb-in.

Screws not used to install breakers should be installed in all open breaker positions to be available for future breaker installation.

To obtain replacement screws order catalog number: P1SCRWS

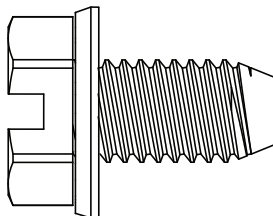
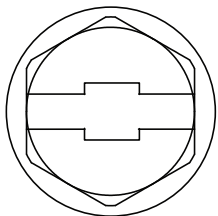

10-32 x 9/32"
Torque to 20 lb-in.

Siemens Industry, Inc.
Norcross, GA