

Commissioning and quick start

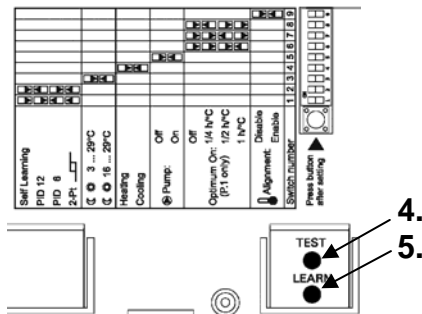

Setting the time of day

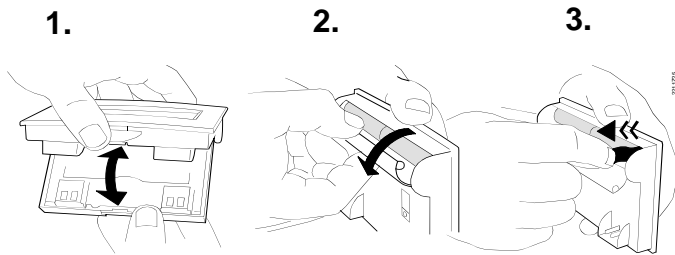
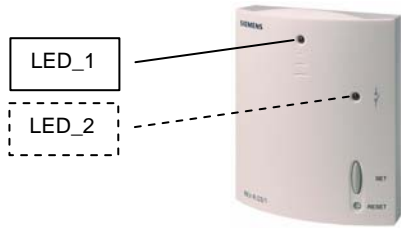
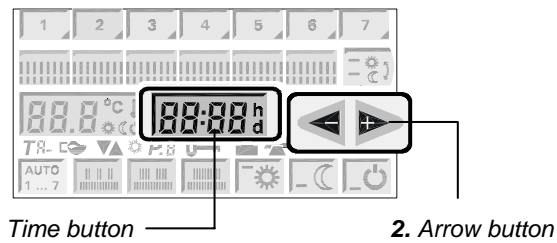

Selecting the day of week

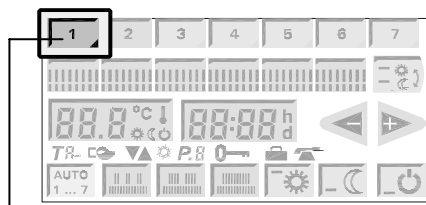

1. Weekday button

Do you want to select an operating mode with automatic changeover of the room temperature level?

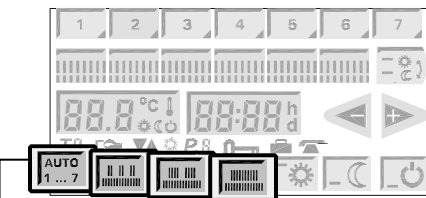

7-day operating mode 24-hour operating modes 1 to 3

Do you want to adjust your individual switching program?

7-day operating mode

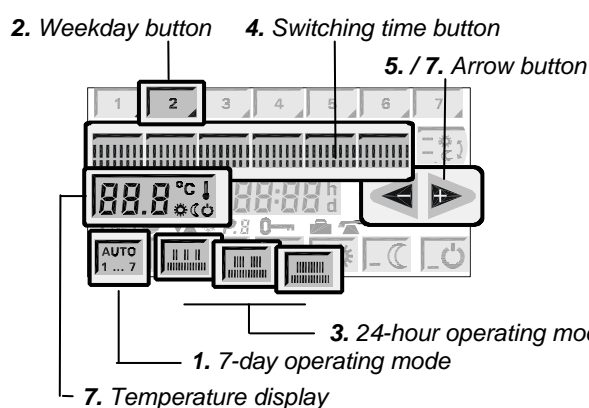

Meaning of the Symbols

- Change batteries
- Locking of display active
- Heating equipment on
- Holiday program active
- Room temperature
- Time of day
- Day
- 24-hour operating modes:
 - 1 Comfort period
 - 2 Comfort periods
 - 3 Comfort periods

Receiver (REV-R.03..)

Switch on power and press "RESET" button for about 4 seconds: Orange LED_2 flashes briefly. Then, press "SET" button for about 3 seconds: Orange LED_2 flashes slowly; learning mode is active. Within 25 minutes press "LEARN" button on REV200...RF for about 4 seconds: Orange LED_2 flashes fast and briefly; LED_1 changes from red to flashing green. After commissioning, the unit will operate automatically.

Transmitter (REV200...RF)

The REV200...RF features a back-lit touch screen display. Settings are made by touching the display fields with the fingers, which also switches on the display lighting.

Tip: To simplify programming, the unit can be removed from its base.

1. Remove the unit from its base
2. Open the cover of the battery compartment.
3. Remove the black transit tab from the batteries. The unit will switch itself on.
4. Press the "TEST" button approximately for 4 seconds to transmit test telegrams.
5. Press the "LEARN" button approximately for 4 seconds to transmit learning telegram.

Setting the correct time of day

1. Select the time button.
2. Set the correct time of day with the arrow buttons. Longer pressing causes the display to accelerate, which can be stopped by repeated pressing.
3. After 5 seconds, the display will automatically return to the initial operating mode. The same action is achieved by touching the time button again.

Select the current weekday

1. Touch the weekday button with the black triangle. The display now shows only the weekdays. Select the current weekday (1=Mo, 2=Tu, etc.).
2. After 5 seconds, the display will automatically return to the initial operating mode. The same action is achieved by touching the selected weekday button again.

Operating mode	Comfort periods		
	07:00 – 23:00		
	06:00 – 08:00	17:00 – 22:00	
	06:00 – 08:00	11:00 – 13:00	17:00 – 22:00
Auto 1...7	Mo – Fr: (1...5)	Sa + So: (6+7)	

7-day operating mode

You can adjust a different switching pattern for each weekday. Each weekday can be selected individually.

1. Touch the 7-day operating mode (Auto 1...7).
2. Select the weekday to be programmed.
3. Touch one of the three 24-hour operating modes.
4. Touch the switching time button where you want to change the time. The respective pointer on the switching time button and the time of day are flashing.
5. Use the arrow buttons to change the displayed switching time.

Note: If two or more switching times are allocated to the same switching time button, press the same button again to select next switching time.

6. Touch the temperature display.
7. Use the arrow buttons to change the displayed temperature.

Tip: Check the settings made by selecting the individual days.

• **24-hour operating mode**

2. Switching time button 3. / 5. Arrow button

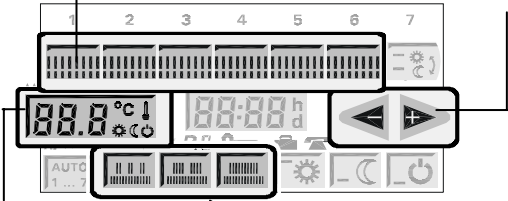

4. Temperature display 1. 24-hour operating modes

Do you want to change the room temperature level for a short time? (economy tip)

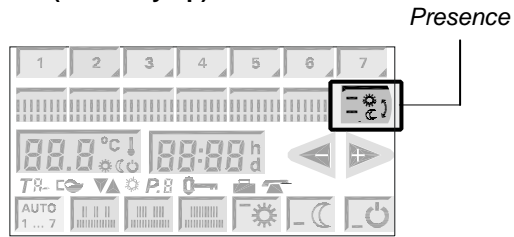

Do you want continuous operation without changing the room temperature level?

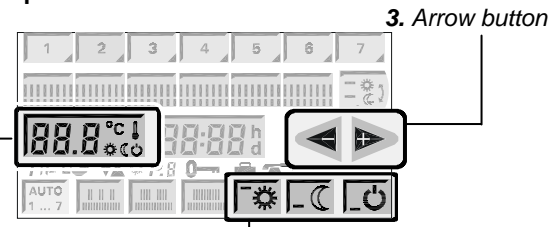

2. Temperature display button 3. Arrow button

Are you going on holiday?

• **Activating the holiday function**

4. Start day 2. 24-hour button 3. Arrow button

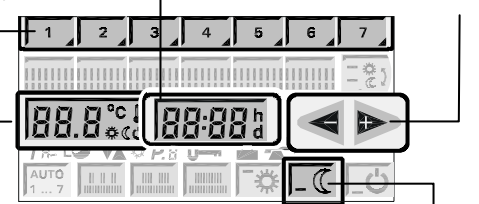

5. Temperature display button 1. Operating mode button

• **Displaying and cancelling the holiday function**

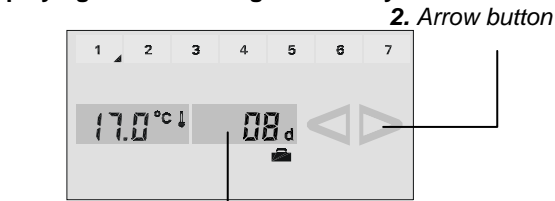

1. 24-hour button

Do you want to return to the default settings?

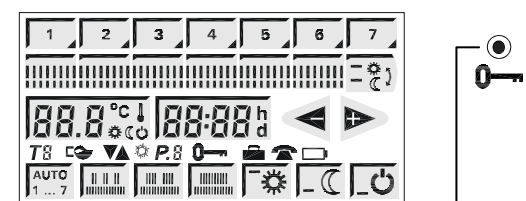

Reset button

Cleaning the display / maintenance

To clean the unit, use the antistatic cloth provided or a soft damp cloth with no chemical cleaning agent. To clean the display, the operating fields can be locked.

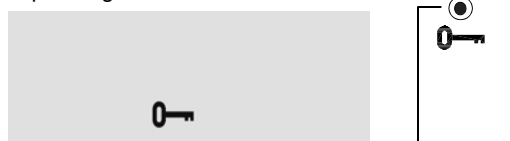

Reset button

Does symbol  appear on the display?

When this symbol appears, you need to replace the batteries within the next 3 months.

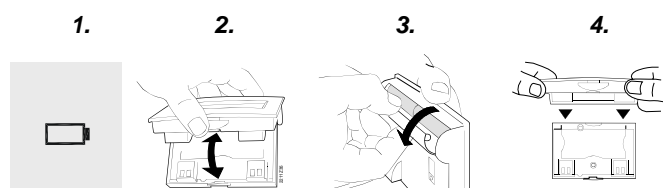

24-hour operating mode

This means that the same switching pattern is used for every day. Individual weekday settings are not possible.

1. Touch one of the three 24-hour operating modes.
2. Touch the switching time button where you want to change the time. The respective pointer on the switching time button and the switching time are flashing.
3. Use the arrow buttons to change the displayed switching time.

Note: If two or more switching times are allocated to the same switching time button, press the same button again to select next switching time.

4. Touch the temperature display button.
5. Use the arrow buttons to change the displayed temperature.

With the presence button, you change from the current room temperature level to the other for a short period of time. The active level will be displayed: * or C. Use this function to reduce the room temperature level when the apartment is unoccupied.

Select the required continuous operating mode. The respective temperature level will be maintained.

	Default value
* Continuously normal temperature	21 °C
C Continuously economy temperature	16 °C
⏻ Continuously OFF (standby) with frost protection	5 °C

Do you want to change these default values?

1. Select the required continuous operating mode.
2. Touch the temperature display button.
3. Change the temperature with the arrow buttons.

When absent for a longer period of time, it is possible to change to the economy temperature and to enter the time of absence.

1. Select operating mode «Economy temperature».
2. Touch the 24-hour button.
3. Enter the number of days you are absent (0..99).
4. Preselect the start day 1..7 of the holiday period.
5. Change the current economy temperature by touching the temperature button and by changing the value with the arrow button.
6. After 8 seconds, the display will automatically return to the initial operating mode. The same action is achieved by touching the time button again.

The display keeps showing the number of days and the holiday symbol. Every midnight, the counter subtracts one day. When the counter reaches "00", an automatic change to the previous program will take place.

Cancelling the holiday function:

1. Touch the 24-hour button.
2. Use the arrow button to set to "00".
3. After 8 seconds, the display will automatically return to the initial operating mode. The same action is achieved by touching the 24-hour button again.

Press the reset button at top right for **at least 3 seconds**: this will reset all individual settings and the time of day to their default values. During the reset time of 3 second, the display will be fully lit, indicating that it works correctly.

Note: After each reset, all individual settings such as time of day, switching times and temperatures etc. must be reentered.

Switching on: Press the reset button at top right for a **maximum** of 1 second:  appears and all other displays will disappear. The operating fields are now out of operation while all the other functions in the background remain fully operational.

Switching off: Press the reset button at top right for a **maximum** of 1 second.

Locking of the display also serves as a protection against tampering.

Note: The settings are retained for a maximum of 1 minute. Do not activate the display lighting too often since this reduces the batteries' life.

1. Get 2 new alkaline batteries type AA, 1.5 V.
2. Open the unit by pressing the button and remove it from its base.
3. Change the batteries.
4. Fit the unit at the top, swing it down and snap on at the bottom.

Make certain exhausted batteries are disposed of properly! The batteries' life expectancy is about 2 years.