

REVISION	DATE	BY	DATE	BY
		DRAWN	11/05/27	MC
		CHEK'D		
		VERIF'D		

<b>Siemens Industry, Inc.</b> Building Technologies Division	
CUSTOMER	
ORDER NO.	DWG. NO.
	1D1Y075BCTP1
SH 1 OF 2	

# SIEMENS

CATALOG NO. 1D1Y075BCTP1  
 SERIAL NO. SERIES H  
 75 kVA 60 Hz 1 PHASE  
 3.4 % IMP AT 100 °C

80 °C RISE 30 °C AVG. AMBIENT  
 220 °C TEMP CLASS 40 °C MAX. AMBIENT  
 PRIMARY ( H1 H3 H2 H4 ) 240X480V V  
 SECONDARY( X4 X2 X3 X1 ) 120/240V V

WINDING MATERIAL CU  
 ENCLOSURE TYPE NEMA-3R  
 WEIGHT 700 LBS

SPACINGS BETWEEN ANY VENTILATED ENCLOSURE PANEL AND ANY ADJACENT WALL SHALL BE A MINIMUM OF 5 INCHES  
 MEETS NEMA TP-1 EFFICIENCY REQUIREMENTS

SUITABLE FOR INDOOR OR OUTDOOR LOCATIONS  
 DO NOT INSTALL IN AREAS ACCESSIBLE TO PUBLIC  
 NE PAS INSTALLER DANS DES ENDROITS ACCESSIBLES AU PUBLIC  
 FOR INSTALLATION SEE INSTRUCTION MANUAL

NEMA Class ANN Dry Type Transformer Siemens Industry, Inc. Norcross, GA

HAM1006

VOLTS	INPUT LINE ON H1 & H4
504	H2-1, H3-2
492	H3-2, H2-3
480	H2-3, H3-4
468	H3-4, H2-5
456	H2-5, H3-6
444	H3-6, H2-7
432	H2-7, H3-8
252	H2-1, H3-2
240	H2-3, H3-4
228	H2-5, H3-6
216	H2-7, H3-8

CONNECT H1 TO H3 AND H2 TO H4 FOR PARALLEL PRIMARY

VOLTS	CONNECT	OUTPUT LINE
120	X1-X3, X2-X4	X1-X4
240	X2-X3	X1-X4
120/240	X2-X3	X1-X2-X4

UL E112313 LR 3902  
 TYPE F LISTED DISTRIBUTION TRANSFORMER 77US



1D1Y075BCTP1

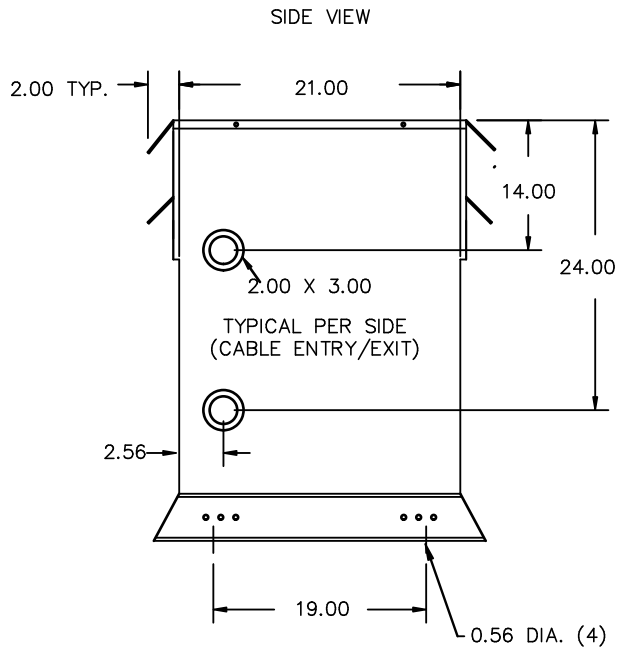
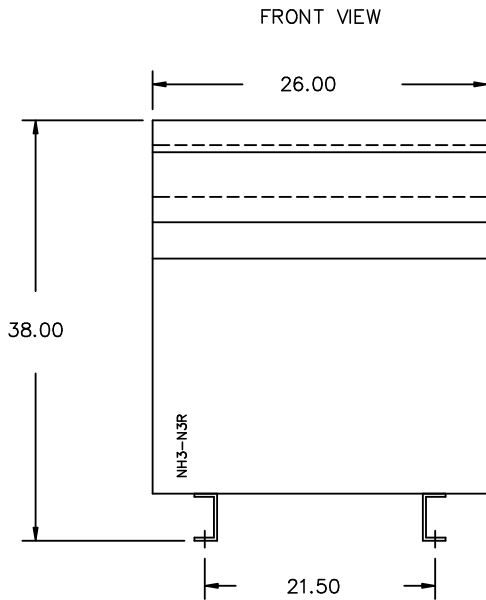

All Dimensions in inches

ENCLOSURE COLOR :ANSI 61 GREY- OUTDOOR

H.V.1. TERMINAL DETAIL

L.V.1. TERMINAL DETAIL

MECHANICAL TYPE LUGS INCLUDED  
SUITABLE FOR 350MCM-6 CU/AL  
CONDUCTORS  
1 CONDUCTOR PER PHASE

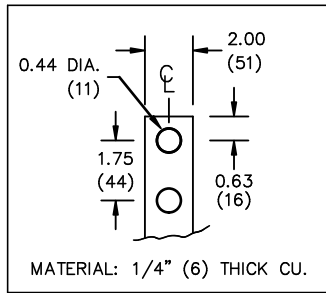

CUSTOMER NOTES:

- HV1 TERMINATED AT TOP FRONT
- LV1 TERMINATED AT BOTTOM FRONT

**Siemens Industry, Inc.**  
Building Technologies Division

REVISION	DATE	BY	DATE	BY	CUSTOMER		
			11/05/27	MC			
			CHEK'D				
			VERIF'D				
					ORDER NO.	DWG. NO.	
						1D1Y075BCTP1	SH 2 OF 2

0.1 rbhata 2013/05/29 16:12