

EASY AND FAST

BIM-compliant planning of busbar trunking systems – with **SIMARIS busbarplan**

Do you want to plan busbar trunking systems in compliance with BIM and automatically check their constructability according to configuration rules? That is exactly what the free SIMARIS busbarplan software lets you do.

[siemens.com/simarisbusbarplan](https://www.siemens.com/simarisbusbarplan)

Digital twin thanks to plug-in for Autodesk Revit

SIMARIS busbarplan is available in English, German and further languages as a plug-in for Autodesk Revit. Simply download the SIMARIS Suite to begin working with SIMARIS busbarplan. This will allow you to design the digital twin for future-oriented planning in the context of BIM (Building Information Modeling)!

Intuitive configuration of busbar runs

SIMARIS busbarplan lets you select the right busbar trunking systems for your projects, and quickly and easily plan the busbar run layout in the building. Additional components like tap-off units, fire barriers, and connection elements can be selected from dialog boxes.

Automatic constructability check

Routings are automatically checked for constructability according to the latest technical configuration rules.

Easy generation of budget prices, functional parts lists, and tender specification texts

Thanks to a smart interface, you can further process your planned busbar trunking systems in SIMARIS project in order to obtain budget prices, functional parts lists, and tender specification texts.

SIEMENS

SIMARIS busbarplan

Functions

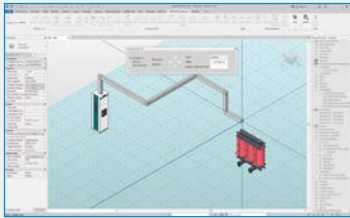

Draw busbar trunking systems

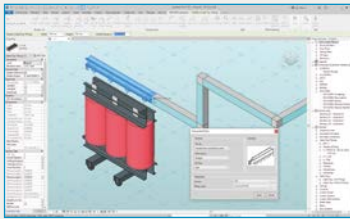

Add components

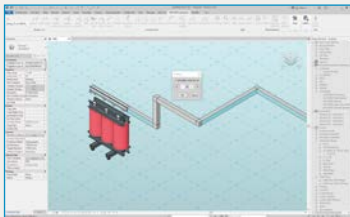

Perform busbar routing

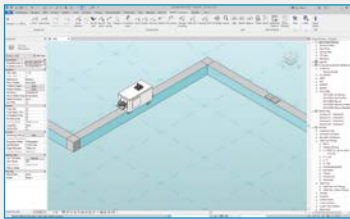

Add tap-off points and tap-off units

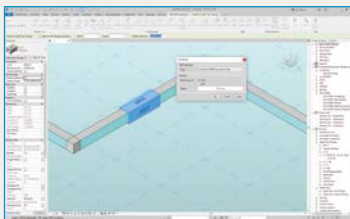

Add fire barrier

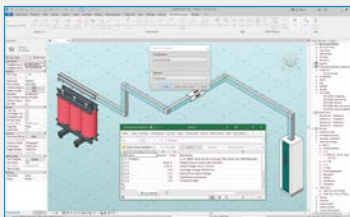

Generate parts list and export file for SIMARIS project

Find our video tutorials at

[siemens.com/simaribusbarplan](https://www.siemens.com/simaribusbarplan)

- Definitions: Select the desired SIVACON 8PS busbar trunking system (LI, LD, LData, BD2, BD01, or LR)
- Drawing: Create busbar run layouts and simply change geometries in the style of standard Revit components (constructability check included)
- Routing: Automatically connect two connection points to a busbar run
- Rotation: Rotate the run on its own axis in 90° and 180° increments while observing the configuration rules
- Assign run: The drawn busbar runs can later be assigned to other runs and configurations
- Tap-off points, tap-off units, fire barriers, and connection elements: dialog box for configuring and positioning
- Edit: Adapt component parameters, e.g. fire barrier, phase distances
- Split: Transfer drawn busbar run layout to busbar run from components
- Unsplit: Transfer busbar run from components to busbar run layout
- Check/notes: Check busbar trunking system layout for possible violations of configuration rules; list located errors as notes
- Functional parts list: System documentation, number of meters, junction units, and export to SIMARIS project
- Language settings: English, German and further languages
- Info: Information on software version

Free SIMARIS busbarplan software

You will find SIMARIS busbarplan in the SIMARIS Suite, where you can quickly and easily download it:

[siemens.com/simaribusbarplan](https://www.siemens.com/simaribusbarplan)

Contact

Our regional SIMARIS contact partners will be pleased to help you with any questions regarding the SIMARIS software and the application in your current project:

[siemens.com/simaribusbarplan/contact](https://www.siemens.com/simaribusbarplan/contact)

For questions about busbar trunking systems, our local SIVACON 8PS contact partners are ready to assist you:

[siemens.com/sivacon8PS-contact](https://www.siemens.com/sivacon8PS-contact)

Published by Siemens AG

Smart Infrastructure
Electrification & Automation
Mozartstrasse 31c
91052 Erlangen
Germany

For the U.S. published by Siemens Industry Inc.

100 Technology Drive
Alpharetta, GA 30005
United States

For more information,
please contact our Customer Support Center:
Phone: +49 9131 1743072
(Charges depending on provider)
E-mail: support.ea.si@siemens.com

Article No. SIEA-B10099-00-7600
Dispo 30407 TH S24-230288 DB 0723
© Siemens 2023

Subject to changes and errors.

The information given in this document only contains general descriptions and/or performance features which may not always specifically reflect those described, or which may undergo modification in the course of further development of the products. The requested performance features are binding only when they are expressly agreed upon in the concluded contract.

All product designations may be trademarks or product names of Siemens AG or other companies whose use by third parties for their own purposes could violate the rights of the owners.